

Table of Contents

- | [Property Details](#)
- | [Location](#)
- | [Pricing Information](#)
- | [Neighbouring Suburbs](#)
- | [Key Documents](#)
- | [Your Local Agents](#)
- | [Helpful Links](#)
- | [Ranges First National - About Us](#)

Property Details





13 Brenda Grove, Tecoma

Is it time for your hills  Tree Change 

3  2  2 

\$795,000 -

\$870,000

An enchanting hills property showcasing the very essence of a residence brimming with character in a picturesque location within the beautiful Dandenong ranges. Earthy tones greet you as you step inside this chalet style home featuring cathedral style timber A ceilings with exposed beam work. The multiple living areas and good-sized kitchen capture the private vista from the large windows and then flows out onto the deck area where you can entertain or relax listening to Ferny Creek meandering through the rear of the property. Three spacious bedrooms with BIR, huge master ensuite with spa bath, shower and toilet, additional bathroom with alcove bathtub & toilet. The study area is ideal for those lucky enough to work from home. Some areas you may wish to upgrade or do the full Hampton Style colour makeover, which is so popular. All privately situated on a  acre appx usable block with separate garage & storage sheds. The township of Tecoma with its shops, schools and petrol station is all a short walk away.

Your contact:-

Grant Skipsey 0418 528 102

<https://www.consumer.vic.gov.au/duediligencechecklist>

Please note: All property details listed were current at the time of publishing.

[Statement of Information](#)



firstnational REAL ESTATE Ranges



firstnational REAL ESTATE Ranges



firstnational REAL ESTATE Ranges



firstnational REAL ESTATE Ranges



firstnational REAL ESTATE Ranges



firstnational REAL ESTATE Ranges







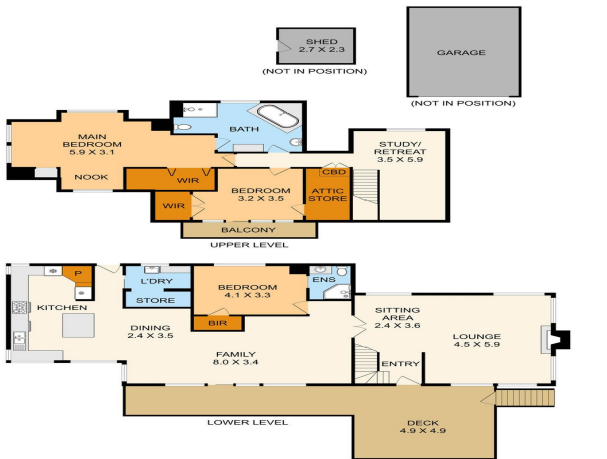

Estimated Internal Area sqm
13 Brenda Grove,



Disclaimer: Please note this floor plan is for illustrative and marketing purposes and is to be used as a guide only. Measurements are approximate and should be confirmed on site. Unless otherwise stated all measurements are in metres and/or square metres.

Location

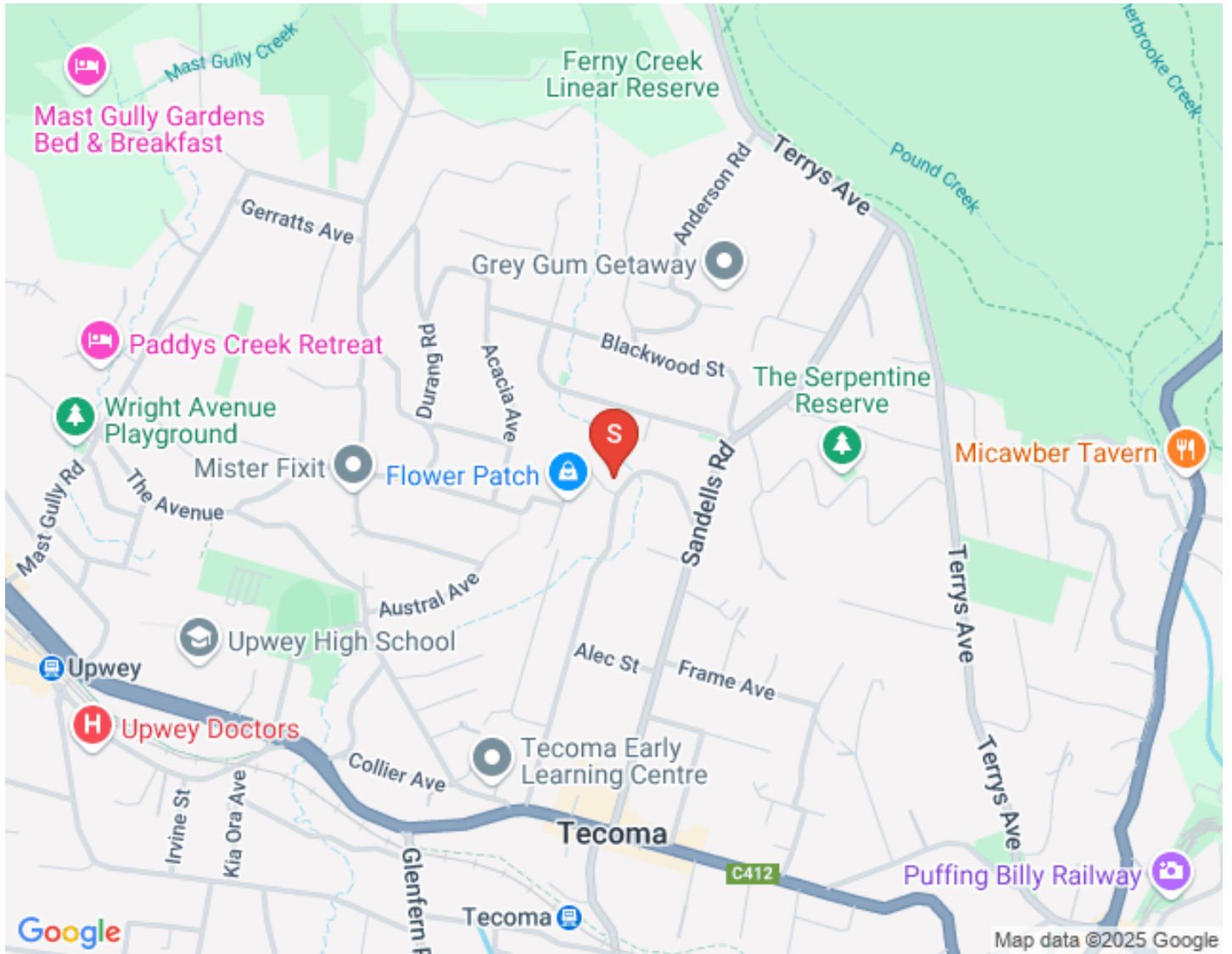

Pricing Information

The property at 13 Brenda Grove, Tecoma is currently for sale at \$795,000 - \$870,000.

Click here to view the [Statement of Information](#)

Neighbouring Suburbs

Belgrave

A Character Of Its Own



Belgrave



Belgrave South

Just a Little South - Click here to find out more about the

- [Belgrave South Suburb Profile](#)

Belgrave South



Cockatoo

A Better Place to Live - Click here to find out more about the

- [Cockatoo Suburb Profile](#)

Cockatoo



Emerald

Get the life you're Looking for - Click here to find out more about the - [Emerald Suburb Profile](#)

Emerald



Ferny Creek

Surrounded by Nature - Click here to find out more about the

- [Ferny Creek Suburb Profile](#)

Ferny Creek

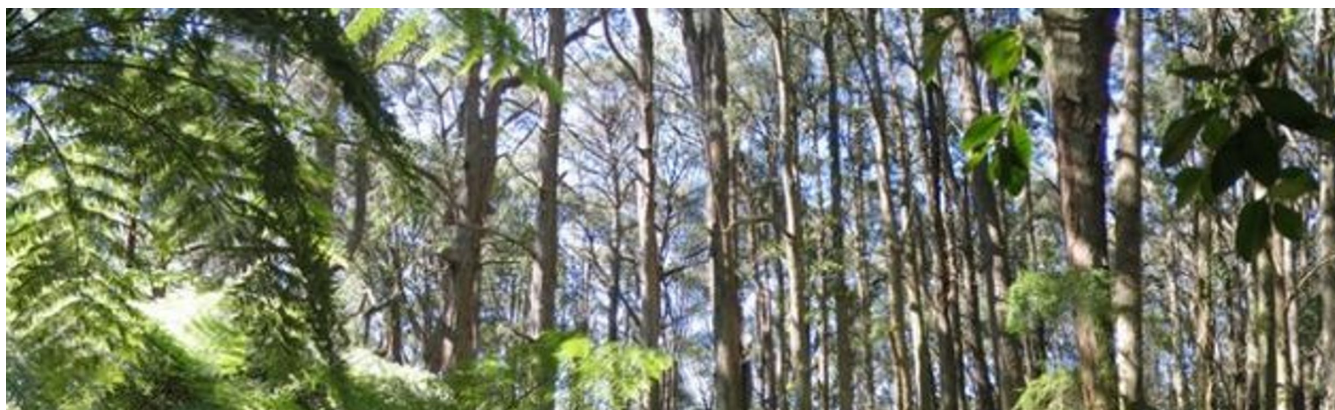

Gembrook

A Destination that Matters - Click here to find out more about the - [Gembrook Suburb Profile](#)

Gembrook



Kallista

Tourisim Village - Click here to find out more about the - [Kallista](#)

[Suburb Profile](#)

 **firstnational**
REAL ESTATE | Ranges

Kallista

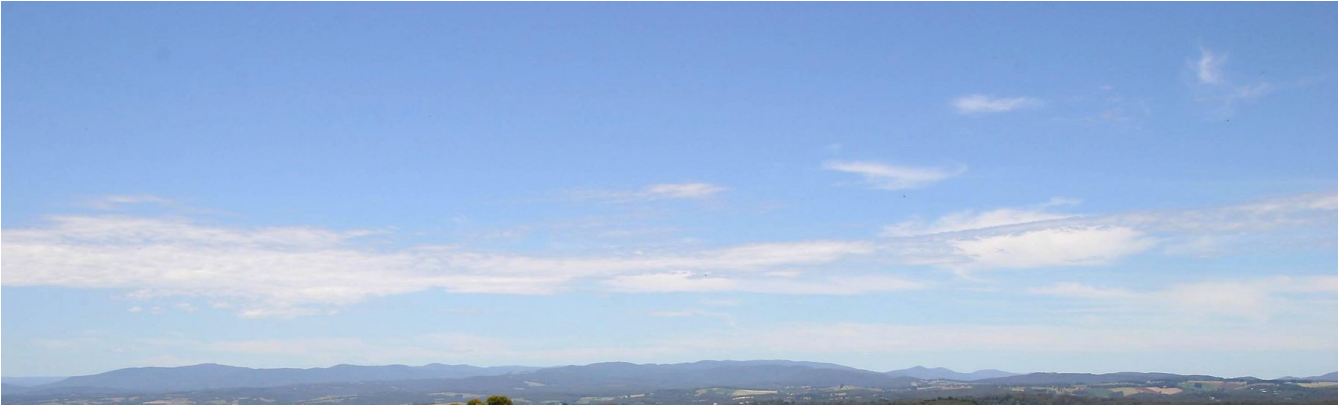

Macclesfield

Horse Lovers Paradise - Click here to find out more about the

- [Macclesfield Suburb Profile](#)



Macclesfield



Menzies Creek

Leafy Green - Click here to find out more about the - [Menzies Creek](#)

[Suburb Profile](#)

Menzies Creek



Monbulk

Hiding Place In The Hills - Click here to find out more about the - [Monbulk Suburb Profile](#)

Monbulk



Olinda

Charming Village - Click here to find out more about the [Olinda](#)

[Suburb Profile](#)

 **firstnational**
REAL ESTATE | Ranges

Olinda



Sassafras

Devonshire Teas And More - Click here to find out more about
the - [Sassafras Suburb Profile](#)



Sassafras



Selby

A Place To Belong - Click here to find out more about the [Selby Suburb Profile](#)



Selby



Tecoma

Don't Miss It! - Click here to find out more about the [Tecoma](#)

[Suburb Profile](#)



Tecoma



The Patch

Small but Scenic - Click here to find out more about the - [The Patch Suburb Profile](#)



The Patch



Upwey

Engage Upwey's Favourite - Click here to find out more about the - [Upwey Suburb Profile](#)

 **firstnational**
REAL ESTATE | Ranges

Upwey



Key Documents

[Download the Due Diligence Checklist](#)

Your Local Agents



GRANT SKIPSEY

SENIOR SALES CONSULTANT

0418 528 102

grants@rangesfn.com.au

Grant has been valuing the local market for over half his life and has not only survived but also thrived with the innovations that have occurred during his 40 years working and living in the local area.

“There have been more changes in our office in the last 5 years than in the previous 30 combined. Each new concept is designed to improve the customer service and results for our clients. I am still amazed at how much more we do today compared to years gone past. Change in Real Estate is inevitable. Growth is optional. It’s a great feeling being a part of the most progressive company in the area.”

Grant received a Gold Sales Award for the 2018, 2019, 2020 & 2022 Gem Awards. This is an outstanding achievement and takes a lot of hard work and persistence to receive such a prestigious award.

Helpful Links



Links

[Home Buyer Guide](#)

[Recent Sales](#)

[New Properties](#)

[Multiple offer form](#)

[Local Property Guide](#)

Ranges First National - About Us

Thank you for viewing the E-Book for 13 Brenda Grove Tecoma, if you would like further information or would like to view this property, please call Grant Skipsey on 0418 528 102.



Welcome to First National Real Estate Ranges

We're dedicated to delivering an exceptional experience from our Belgrave & Cockatoo office's, so every member of our team strives to make a difference. That begins with our promise – ***We put you first.***

When you need real estate services, it's hard to beat a brand that has been independently endorsed as having Australia's most satisfied customers but that's us, so relax.

To find out which real estate agents rate most highly across Australia, Canstar Blue surveyed adults who had employed an agent over the last three years, whether it related to the buying or selling of a property, lease management, or renting. It found First National Real Estate has been impressing more than any other firm, taking out five-star reviews from consumers in almost every single category, including communication and advice, problem resolution and value for money. In fact, no other real estate agent achieved top marks in any area.

So, whether you're looking to rent, buy or sell a property in Avonsleigh, Belgrave, Belgrave Heights, Belgrave South, Clematis, Cockatoo, Emerald, Ferny Creek, Gembrook, Kallista, Macclesfield, Menzies Creek, Monbulk, Olinda, Tecoma, The Patch, Selby, Sassafra, Sherbooke and Upwey our team will help you find the perfect place.

Visit the First National Real Estate Ranges Team at one of the two office locations or call us, 03 9754 6111 or email sales@rangesfn.com.au.

We put you first.

Regards,

The Team at First National Ranges - Belgrave & Cockatoo

